

Ranger 8000

Security Control System

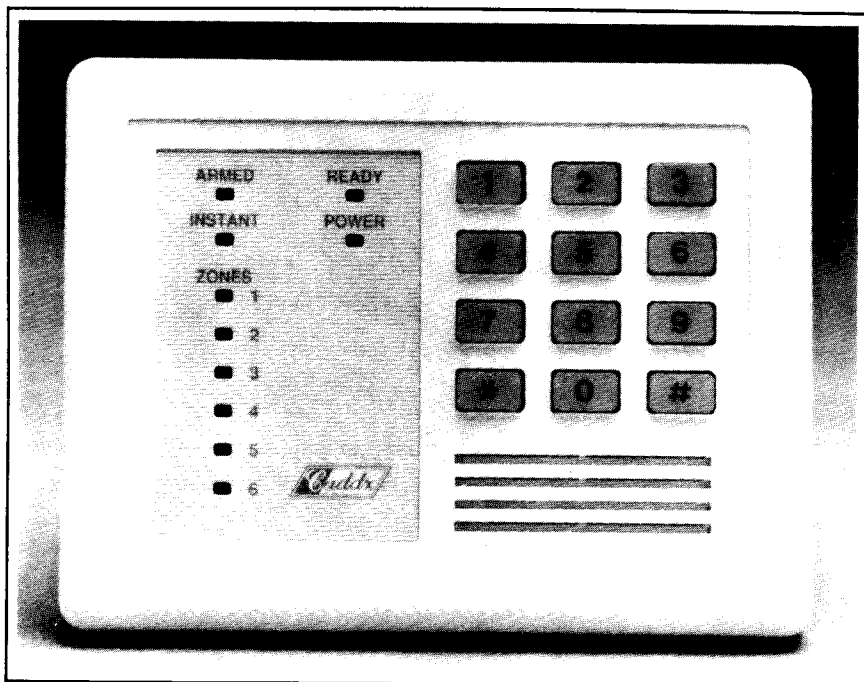

Operator's Manual

CONTROL KEYPAD

READY light indicates all zones are secure or bypassed, and system is ready to arm.

ARMED light indicates system is armed. Flashing **ARMED** light indicates previous alarm.

INSTANT light indicates no entry/exit delay is present.

POWER light indicates AC power is present to your system.

ZONE lights indicate status of zones. On means zone(s) bypassed, flashing means zone(s) open.

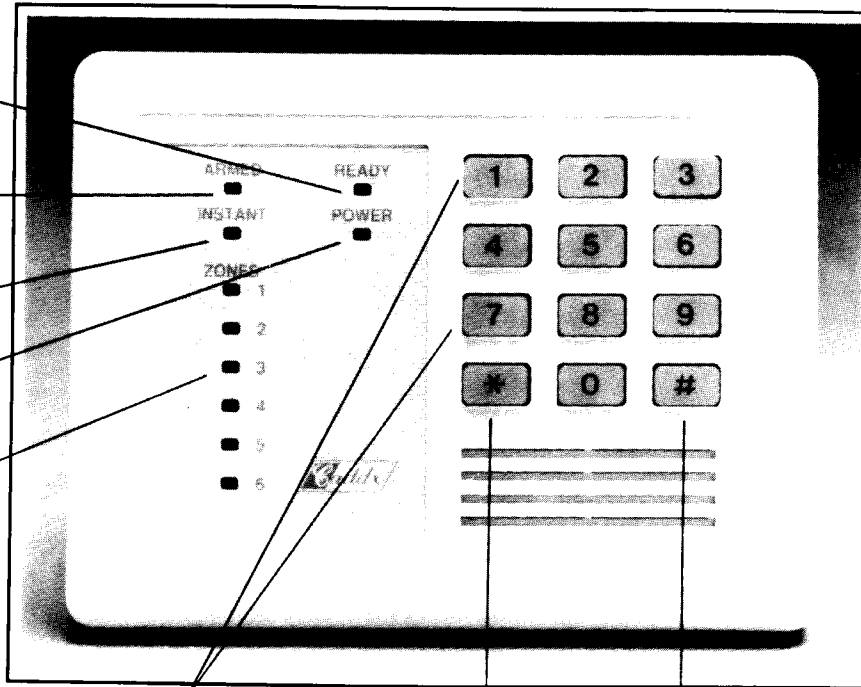

BELL TEST: If programmed by the installer, pressing these buttons simultaneously will activate a local test of the siren/bell. Enter your code to silence.

STAR button is used to remove or regain entry/exit delay. This button is also used during zone bypassing.

POUND button is to reset if an error is made during code entry. Press and re-enter code.

PANIC/HOLD UP ALARM: If programmed by the installer, pressing the [*] and [#] simultaneously for one second will activate a panic/hold up transmission, and sound the local siren/bell.

SECURITY SYSTEM NOTES

Installing/Service Company: _____

For Service Call: _____

Security System Configuration

Master Code: _____

Auxiliary Code "Quick Arm" Digit: _____

2. _____

3. _____

4. _____

5. _____

6. _____

Exit Delay Time _____ Auxiliary Exit Delay Time _____

Entry Delay Time _____ Auxiliary Entry Delay Time _____

Fire Alarm Sound _____

Fire Alarm Sound Steady Siren _____, Pulsing Bell _____

Burglar Alarm Sound Yelp Siren _____, Steady Bell _____

Zone Coverage

ZONE 1: _____

ZONE 2: _____

ZONE 3: _____

ZONE 4: _____

ZONE 5: _____

ZONE 6: _____

Emergency Phone Numbers

Fire Dept.: _____

Police Dept.: _____

Monitoring Center: _____

This manual is furnished to help you understand your security system and become proficient in its operation. All users of your security system should read and follow the instructions and precautions in this booklet. Failure to do so could result in the security system not working properly. This booklet should be kept in an accessible location for the life of the security system. If you do not understand any part of the manual you should notify your installing company and ask for that section of the manual to be explained fully.

The SECURITY CONTROL CENTER is turned on (ARMED) and off (DISARMED) by entering a 4 digit code into the Keypad Control, which is similar to a telephone keypad. The Keypad Control includes 10 indicator lights and a built-in electronic sounder. These provide specific information relating to the status of the security system which is described in this booklet. Understanding what the lights and sounds mean will help you to easily operate your system.

SO REMEMBER, READ THE ENTIRE MANUAL, AND, IF POSSIBLE, PRACTICE ON THE KEYPAD CONTROL WHILE YOUR PROFESSIONAL INSTALLER IS AT YOUR BUILDING. IF YOU HAVE ANY QUESTIONS ASK YOUR INSTALLING COMPANY.

PLEASE KEEP IN MIND THAT THE LEVEL OF SECURITY YOU WILL OBTAIN WITH THIS SYSTEM RELATES SPECIFICALLY TO TWO MAJOR FACTORS:

1. THE QUANTITY, QUALITY, AND PLACEMENT OF SECURITY DEVICES ATTACHED TO THIS SYSTEM.
2. THE KNOWLEDGE YOU HAVE OF THE SECURITY SYSTEM AND HOW THAT KNOWLEDGE IS UTILIZED IN A WEEKLY TEST OF THE COMPLETE SYSTEM.

YOU SHOULD BE AWARE OF THE FOLLOWING FACTS AND USE THEM WHEN PREPARING A SAFETY/SECURITY PLAN FOR YOUR HOME/BUSINESS.

- YOUR SECURITY SYSTEM IS AN ELECTRONIC DEVICE AND IS SUBJECT TO MALFUNCTION OR FAILURE. DO NOT RELY ON IT AS YOUR SINGLE SOURCE OF SECURITY.
- YOUR SYSTEM SHOULD BE TESTED WEEKLY.
- YOUR SYSTEM WILL NOT WORK WITHOUT POWER.
- WARNING DEVICES WILL NEED TO BE LOUD ENOUGH, WIRED CORRECTLY, AND PROPERLY PLACED TO PROVIDE NOTIFICATION OF AN ALARM EVENT.
- SMOKE AND HEAT DETECTORS MAY NOT DETECT FIRE AND SMOKE IN ALL SITUATIONS.
- USE QUALIFIED SECURITY PROFESSIONALS TO SELECT, INSTALL, AND MAINTAIN YOUR SECURITY SYSTEM.
- IT MAY BE POSSIBLE TO ARM THE SECURITY SYSTEM WITHOUT THE BACK-UP BATTERY CONNECTED. YOUR PERIODIC TEST SHOULD BE DONE WITH A.C. POWER REMOVED TO VERIFY THE BATTERY IS CONNECTED AND ADEQUATELY CHARGED.
- CARE SHOULD BE TAKEN TO PLUG-IN AND PROPERLY RESTRAIN THE A.C. TRANSFORMER AFTER TESTING.

PLEASE READ THE FOLLOWING INFORMATION AND INSTRUCTIONS COMPLETELY BEFORE OPERATING YOUR SECURITY CONTROL SYSTEM. IF YOU DO NOT UNDERSTAND ANY PORTION OF THIS MANUAL, OR IF YOU HAVE ANY QUESTIONS ABOUT YOUR SYSTEM, CONTACT THE INSTALLING COMPANY LISTED ON PAGE 1 OF THIS BOOKLET.

HOW TO ARM YOUR SECURITY SYSTEM

To turn the security system on, close all of the protected doors and windows. The green "READY" light on the Keypad Control will be illuminated when all the protected areas and sensors are secure. If any of the zones are bypassed, a sensor in that zone can be violated without affecting the "READY" light.

The Security System will not arm if the "READY" light is not illuminated. With the "READY" light on, you may arm the Security System with your Master Code or one of the Auxiliary Codes.

Each time a key is pressed on the Keypad Control, a short tone (beep) will sound. If the Keypad Control sounds (beeps) three (3) times after code entry, it is an indication that the code has not been accepted. Press the reset [#] key and re-enter a valid code.

If the Keypad Control sounds (beeps) continuously after code entry, it is an indication that the "POWER" light is off, or of another Trouble condition. The keypad sounder can be silenced by re-entering your 4 digit code. If the "POWER" light is out, you should restore power if possible. If the "POWER" light is on, press the [#] key (reset), wait 10 seconds and re-enter your 4 digit code. If you are unable to correct the above conditions contact the installing company listed on page 1 of this booklet for service.

When the Security System has accepted a valid code, the red "ARMED" light will illuminate, indicating that the system has been turned on. If you choose to leave the protected area, you must exit through the predesignated ENTRY/EXIT door(s). If you remain inside the protected area, insure that all interior zones which may be tripped by your movement are bypassed.

AUTOMATIC BYPASS ARMING

If the "AUTOMATIC BYPASS" option has been selected by your installing company, all interior zones will automatically bypass if you "ARM" your security system and do not exit through a designated entry/exit door. The "AUTOMATIC BYPASS" will occur at the end of the exit delay time. At this time, all bypassed zone lights will become illuminated. With the interior zones bypassed, occupants are allowed freedom of movement inside of the home/business while the security system is "ARMED"

INSTANT/DELAY OPTION

If your security system is "ARMED" and you DO NOT wish to have a delay on your entry/exit doors, this can be accomplished by pressing the [★] key on your keypad. At this time, the "INSTANT" light will become illuminated and there will be no entry/exit delay present. Any time the "INSTANT" light is on, the opening of an entry/exit door will cause an immediate alarm, making this feature ideal for use at night, or when no authorized entries or exits are anticipated. By pressing the [★] key again, the "INSTANT" light will go off, and an ENTRY delay will become present on designated entry/exit doors.

NOTE: Your installing company may have programmed the "INSTANT" option to occur in conjunction with the "AUTOMATIC BYPASS" feature. In this case, the "INSTANT" light and the bypassed zone lights will become illuminated at the end of the exit delay. If this occurs, you still have the ability to turn off/on the "INSTANT" feature by pressing the [★] key.

HOW TO DISARM YOUR SECURITY SYSTEM

When you enter the protected area through one of the designated entry/exit doors, the Keypad Control will sound a continuous tone (beep) for the duration of the entry delay time or until you enter a valid code. After a valid code is entered, the red "ARMED" light will then go out and the tone will stop. The security system is now disarmed. If a valid code is not entered before the end of the entry delay time, an alarm will occur. (NOTE: IF THE RED "ARMED" LIGHT IS FLASHING AT ENTRY, THE ALARM HAS BEEN ACTIVATED IN YOUR ABSENCE. LEAVE THE BUILDING IMMEDIATELY AND CALL YOUR ALARM COMPANY AND/OR THE POLICE FROM A SAFE LOCATION.)

HOW TO BYPASS ZONES

To bypass any of the zones 1-6, disarm the control and press star [★], zone NUMBER(S) to be bypassed, and star [★]. Zones cannot be bypassed if the control is armed. When the Security System is disarmed, all bypassed zones will clear to the normal status. As bypassed zones are unprotected, this procedure should not be given to unauthorized persons.

MANUAL PANIC/HOLD-UP ALARM

When the star [★] and pound [#] keys are pressed at the same time for one (1) second, the local audible alarm will sound. If your system is connected to a monitoring center, an emergency report could be transmitted to that center. These keys should only be pressed in an emergency situation requiring immediate response by law enforcement personnel.

PLEASE NOTE! Some Panic/Hold-up alarms are programmed to be silent at the protected building while reporting an alarm to the monitoring center. Check with your installing company to determine how your Security System will respond to the Panic/Hold-up input.

MANUAL FIRE ALARM

If the "MANUAL FIRE" option has been selected by your installing company, you can activate the steady siren or pulsing bell by pressing the one [1] and three [3] keys at the same time for one (1) second. If your system is connected to a monitoring center, an emergency report could be reported to that center. These keys should only be pressed in an emergency situation requiring response by fire department personnel.

FIRE ZONE

When local fire codes allow it, your security system may have one or more zones configured as a "FIRE" zone. When this option is selected, and approved smoke or heat detectors are attached to the selected zone(s), a unique audible sound can be initiated from the security system. You should familiarize your family or staff with this sound and follow an evacuation plan if this fire warning sound is heard. (see page 8 for assistance in formulating an evacuation plan)

To silence the audible fire alarm, enter a valid code. To reset the smoke detector press the "RESET" [#] key. After 10 seconds the zone light designated for "FIRE", and the light on the affected smoke detector should turn off. If you are unable to reset your system after the smoke detector chamber has been cleared of smoke, you should immediately call the service phone number listed on page 1 of this booklet.

PROGRAMMING ACCESS CODES

The Security System can be armed and disarmed by the Master Code (User Code #1) and up to five (5) Auxiliary Codes. All codes must have four (4) digits. These Auxiliary codes are individually numbered from 2 to 6. If Auxiliary Codes are desired, they must be programmed individually. Only persons knowing the Master Code (User Code #1) can assign or change Auxiliary codes. (See programming Auxiliary codes below).

CHANGING THE MASTER CODE - The Master Code is User Code #1 and must be programmed by referring to its code number. For example, if the Master Code is [1] [2] [3] [4] and you want to change it to [5] [3] [4] [2], the sequence would be as follows: Press [*] [1] [#], (this enters programming for user code #1) then [1] [2] [3] [4] (old Master Code) Press [*] [1] [#], verifying that user code #1 is being changed, then new code [5] [3] [4] [2]. Now end this sequence by pressing [*] [1] [#] to exit programming.

The entire sequence would consist of pressing 17 keys as follows:

[*] [1] [#] - [1] [2] [3] [4] - [*] [1] [#] - [5] [3] [4] [2] - [*] [1] [#]

IMPORTANT!! Changing the Master code will invalidate your Duress Code and all auxiliary codes. After changing the Master code, you must reprogram these codes.

PROGRAMMING AUXILIARY CODES - In order to program Auxiliary Codes you must know the Master Code. As stated earlier, each Auxiliary Code has its own unique number from 2 to 6 and must be referred to by its' number. It is programmed much like the Master Code. For example, to program Auxiliary Code #2 the sequence would be as follows:

[*] [2] [#] - [5] [3] [4] [2] [*] [2] [#] - [] [] [] [] - [*] [2] [#]
(New Code)

REMOVING AUXILIARY CODES - To remove an Auxiliary Code simply program it to be the Master Code. For example, to remove user code #2, the sequence would be as follows:

[*] [2] [#] - [5] [3] [4] [2] - [*] [2] [#] - [5] [3] [4] [2] - [*] [2] [#]

User code #2 has now been eliminated.

DURESS CODE - Your Security System may include a "DURESS" option. If so, this code may be programmed to send a special message to the central monitoring station if you are forced to arm or disarm your security system against your will. Check with your installing/service company to determine if this feature has been enabled for your system.

IMPORTANT!! Changing the Master code will invalidate your Duress Code. After changing the Master Code, you **MUST** reprogram your Duress Code.

"QUICK-ARM" FEATURE

Your security system may have a "QUICK ARM" Code programmed. If so, this feature will allow you to arm the Security System by pressing one pre-designated key on the keypad. This "QUICK-ARM" code is for **Arming Only** and will not disarm the Security System. This makes it ideal for a maid code, babysitter code, etc. This code can only be programmed and changed by your installing company.

EMERGENCY EVACUATION PLANS

An emergency evacuation plan should be established for an actual fire alarm condition. For example, the following steps are recommended by the National Fire Protection Association and can be used as a guide in establishing an evacuation plan for your building.

Draw up a floor plan of your home. Show windows, doors, stairs, and rooftops that can be used for escape. Indicate each occupant's escape routes. Always keep these routes free from obstruction.

Determine two means of escape from each room. One will be the normal exit from the building. The other may be a window that opens easily. An escape ladder may have to be located near the window if there is a long drop to the ground below.

Set a meeting place outdoors for a headcount of the building occupants.

Practice escape procedures. In a home, sleep with bedroom door closed; this will increase your escape time. If you suspect fire, test the door for heat. If you think it is safe, brace your shoulder against the door and open it cautiously. Be ready to slam the door if smoke or heat rush in. Practice escaping to the outdoors and meeting in an assigned spot. Call the Fire Department from a neighbor's phone.

NOTE: After the installation of your Security System has been completed, notify your local Fire and Police Departments to give them your name and address for their records.

Early warning fire detection is best achieved by the installation of fire detection equipment in all rooms.

This equipment should be installed in accordance with the National Fire Protection Association's Standard 74. For additional information write the National Fire Protection Association, Batterymarch Park, Quincy, MA 02269.

The following are examples of evacuation plans. A plan unique to your home or business should be drawn and memorized by each occupant.

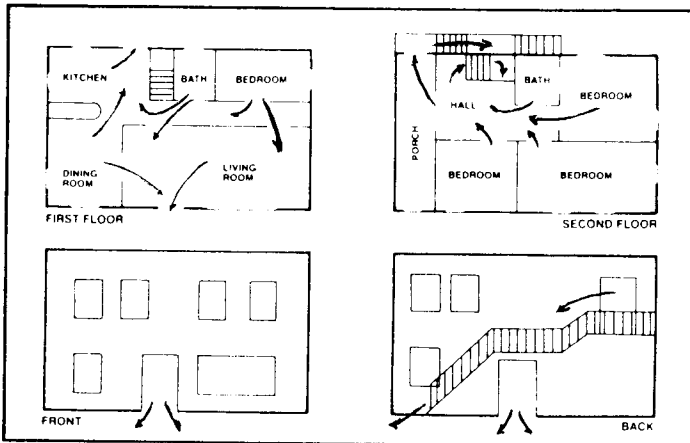

SYSTEM NOTES



Caddx-Caddi Controls, Inc.

1420 N. Main Street • Gladewater, Texas 75647 • 903-845-6941 • FAX 903-845-6811

BULLETIN #OM-8000